

Operation Manual



Extended Hold Bin
EHB34-CE Series



CAUTION: Read the instructions before using the machine.

Find language translations of this document at bk.princecastle.com.

اعثر على ترجمات لغوية لهذا المستند على bk.princecastle.com.

Finden Sie Sprachübersetzungen dieses Dokuments unter bk.princecastle.com.

Encuentre traducciones de este documento en bk.princecastle.com.

Trouvez les traductions de ce document sur bk.princecastle.com.

Trova le traduzioni linguistiche di questo documento su bk.princecastle.com.

Znajdź tłumaczenia tego dokumentu na bk.princecastle.com.

Найти языковые переводы этого документа на bk.princecastle.com.

Bu belgenin dil çevirilerini bk.princecastle.com adresinden bulabilirsiniz.

Encontre traduções de idiomas deste documento em bk.princecastle.com.

LIMITED WARRANTY

Subject to the terms and conditions set forth herein, the manufacturer warrants that the product shall be free from defects in materials and workmanship for a period of three (3) years from the date of original installation. This warranty applies to both repair parts and service labor; notwithstanding the foregoing, the warranty commencement date shall not exceed ninety (90) days from the date of manufacture, regardless of the actual installation date.

Timer bar components and associated kits are separately warranted to be free from defects in materials and workmanship for a period of five (5) years from the applicable warranty commencement date. Following the expiration of the initial three (3) year equipment warranty period, coverage shall be limited exclusively to parts and shall no longer include service labor.

This warranty is subject to the following exceptions/conditions:

- Use of any non-genuine Prince Castle parts voids this warranty.
- All labor to be performed during regular work hours. Overtime premium (the incremental amount) will be charged to the customer.
- Damage caused by carelessness, neglect and/or abuse (e.g., dropping, tampering or altering parts, equipment damaged in shipment, by fire, flood or an act of nature) is not covered under this warranty.
- All problems due to operation at voltages other than that specified on equipment nameplates are not covered by this warranty. Conversion to correct voltage is the customer's responsibility.
- This equipment must be serviced by Prince Castle Authorized Service Agency or a Prince Castle Service Technician during the warranty period.

Note: When connected to the Kitchen Minder, the Transfer and Menu functions are disabled on the button bar.

TABLE OF CONTENTS

| | |
|---|----|
| Model Identification | 2 |
| Model Specifications | 3 |
| Safety Information | 3 |
| Installation | 3 |
| Product Identification | 4 |
| Operation | 4 |
| Setting the Temperature | 6 |
| Calibrating the Heaters | 7 |
| Changing the Hold and Cook More Times | 8 |
| Changing Product Names | 9 |
| Changing Temperature Scale | 10 |
| Adjusting Alarm Volume | 10 |
| Selecting the Daypart | 11 |
| Setting Product Location | 12 |
| Cleaning | 12 |
| Default Menu | 13 |
| Zone Layouts | 13 |
| Troubleshooting | 14 |
| Diagnostics | 15 |
| Wiring Diagram | 16 |
| Exploded Views | 17 |

355 EAST KEHOE BLVD. ~ CAROL STREAM, IL, 60188, USA
PHONE: 630-462-8800 ~ TOLL FREE: 1-800-PCASTLE
FAX 630-462-1460 ~ WWW.PRINCECASTLE.COM



Dedicated Holding Bin

EHB34-CE Series



Model Identification

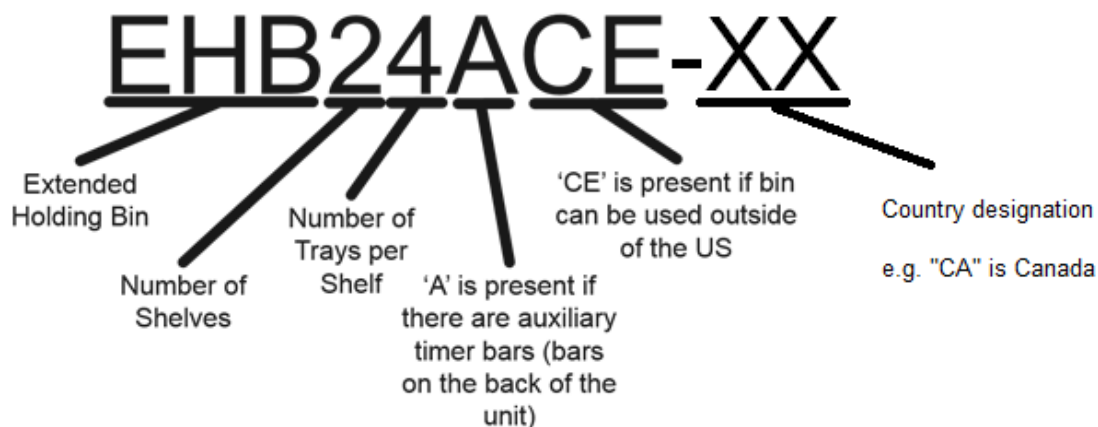

Serial Number Matrix

The manufacture date is encoded in the unit's serial number.
The service bench installation date (used to determine warranty coverage) is considered to be the end of the following month. For example:

Serial Number: JL0173804

Manufacture Date: September 2016

Service Bench Installation Date: October 31, 2016

| | | SERIAL NUMBER MATRIX | | | | | | | |
|-----------|---|----------------------|------|------|------|------|------|------|------|
| | | 2016 | 2017 | 2018 | 2019 | 2020 | 2021 | 2022 | 2023 |
| | | L | M | N | P | R | S | T | U |
| January | A | AL | AM | AN | AP | AR | AS | AT | AU |
| February | B | BL | BM | BN | BP | BR | BS | BT | BU |
| March | C | CL | CM | CN | CP | CR | CS | CT | CU |
| April | D | DL | DM | DN | DP | DR | DS | DT | DU |
| May | E | EL | EM | EN | EP | ER | ES | ET | EU |
| June | F | FL | FM | FN | FP | FR | FS | FT | FU |
| July | G | GL | GM | GN | GP | GR | GS | GT | GU |
| August | H | HL | HM | HN | HP | HR | HS | HT | HU |
| September | J | JL | JM | JN | JP | JR | JS | JT | JU |
| October | K | KL | KM | KN | KP | KR | KS | KT | KU |
| November | L | LL | LM | LN | LP | LR | LS | LT | LU |
| December | M | ML | MM | MN | MP | MR | MS | MT | MU |

Model Specifications

| STYLE | WIDTH (mm) | HEIGHT (mm) | DEPTH (mm) | WEIGHT (kgs) | VOLTAGE | WATTS | PLUG |
|---------|-------------|-------------|-------------|--------------|----------|------------|---------|
| 3H X 4W | 33.2" (843) | 16.2" (413) | 14.1" (358) | 83 lbs (38) | 208-240V | 2820-3760W | IEC 309 |

NOTE:

Weight (kgs) is product weight.

Safety Information



WARNING

Indicates information important to the proper operation of the unit. Failure to observe may result in damage to the equipment and/or severe bodily injury or death.



CAUTION

Indicates information important to the operation of the unit. Failure to observe may result in damage to the equipment.

Important

Prince Castle reserves the right to change specifications and product design without notice. Such revisions do not entitle the buyer to corresponding changes, improvements, additions or replacements for previously purchased equipment.

Children shall not play with appliance.

Cleaning and user maintenance shall not be made by children without supervision

Installation



WARNING: This application is not intended for use by persons (including children) with reduced physical, sensory or mental capabilities, or lack of experience and knowledge, unless they have been given supervision or instruction concerning use of the appliance by a person responsible for their safety.

1

Remove the unit from the carton and inspect for signs of damage. If there is damage to the unit:

- notify the carrier within 24 hours of delivery
- save carton and packaging materials for inspection purposes
- contact your local dealer, or if purchased directly, the Prince Castle Sales Department at 800-722-7853 or 1-630-462-8800 to arrange for a replacement unit.

NOTE: Plug the power cord into the proper electrical receptacle. All electrical connections must be in accordance with local electrical codes and any other applicable codes.

2

Place Holding Bin on flat surface.
Clearances: 6" sides, 24" front and back.
Remove blue and/or white protective covering.

NOTE: When installing this unit, the ambient temperature at the mounting site should not exceed 100°F (38°C)

3

Plug unit into a grounded receptacle with a matching plug configuration.

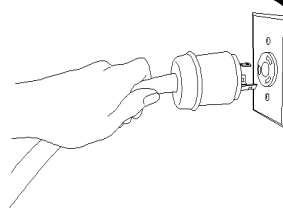

WARNING:

All electrical connections must be in accordance with local electrical codes and any other applicable codes. If the supply cord is damaged, it must be replaced by the manufacturer, its service agent, or similarly qualified persons in order to avoid a hazard.

To prevent an electric shock hazard this device must be bonded to equipment in close proximity with an equipotential bonding conductor. This device is equipped with a grounding lug (identified with the symbol at right) for this purpose.



NOTICE – This product is not intended for connection to the residential public low-voltage supply system

Dedicated Holding Bin

EHB34-CE Series



Product Identification



DISPLAY
Control

Button Bar

Power
ON/OFF
Switch

PAN LIDS, ONLY used with broiled products.
(Fried products DO NOT require lids)



Note: When connected to the Kitchen Minder, programming is disabled on the timer bar.

LED TIMERS (tri-color)
(1 for each pan arrow button)

TRANSFER Button
(Not used)

UP and DOWN ARROW

ENTER Button

BKFT LED
(Breakfast)



BUTTON BAR

PRINCE CASTLE
LOGO Button

PAN ARROW Buttons
(2 for each slot wide)

UPPER PAN Display
(1 for each slot wide)

LOWER PAN Display
(1 for each slot wide)

REG LED
(Regular Menu)

Operation

- 1 To turn on the unit,
Turn Power On/Off switch (A) to **ON** position.



Allow 20 minutes for heaters to reach operating temperature. The button bar will read "WARM UP" as the unit warms up, they will display the product names.

NOTE: Load pan covers (if used) and insert pans into the unit.

- 2 Press all Pan Arrow buttons.
The Pan displays will show the assigned product name.



If no product is assigned, the display will be dim and show "----". Pressing the Pan Arrow button will not activate the timer if "----" is displayed. Pressing Pan Arrow button when product name is displayed will start timing cycle.

BKFT (Breakfast) or **REG** (Regular Menu) will be lit depending on pre-programmed menu.

Operation

3 LED Timing Status



LED TIMERS

BLANK (steady) = Ready for product
RED (flashing) = Discard product
GREEN (steady) = Oldest product, use first
GREEN (flashing) = Cook more product
YELLOW (steady) = Newer product, use green first
YELLOW (flashing) = Cook more product

4 When LED is **BLANK**, load product and press the Pan Arrow button.

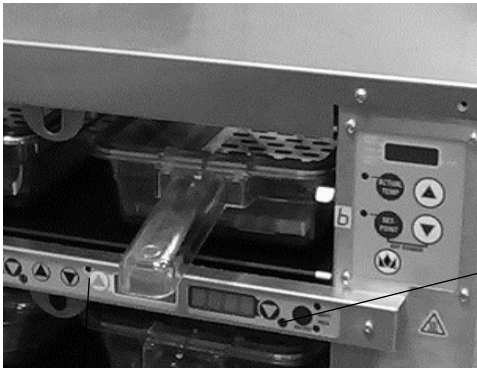

If only one pan is active for a product, the LED will turn from **BLANK** to **GREEN**.

If more than one pan is active for a product, the LED for the first pan loaded will turn from **BLANK** to **GREEN**.

The LED for the 2nd pan loaded with the same product will turn from **BLANK** to **YELLOW**.

The LED timer can be stopped (cancelled) at any time by pressing and releasing the corresponding **PAN** Arrow button.

5 When any of the timer LED flash, cook more product or remove and discard product as indicated.

GREEN (flashing) = Cook more product
YELLOW (flashing) = Cook more product
RED (flashing) = Discard product



WARNING: HOT SURFACES

Dedicated Holding Bin

EHB34-CE Series



Setting the Temperature

The unit has multiple shelves, each with both an upper and lower heater for each zone. The heaters follow the default setpoints of the preset products for each pan. Each heater has a programmable range of 150° – 275°F (66° – 135°C). Use the instructions below and the following steps to set the setpoint temperatures for each heater.

NOTE: Only applicable in stand-alone mode when not connected to Product Management system, setpoint cannot be changed when connected to a kitchen manager.

Note: When connected to the Kitchen Minder, this function is disabled.

UPPER SHELF LED
This LED will be lit to indicate upper shelf is selected.

PROG LED
This LED will be lit to indicate unit is in Program Mode.

LOWER SHELF LED
This LED will be lit to indicate lower shelf is selected.

ACTUAL TEMP BUTTON and LED
Press to display actual temperature for the selected heater. LED will be lit when actual temperature is displayed.

SETPOINT BUTTON and LED
Press to display setpoint temperature of a selected heater. LED will be lit when setpoint temperature is displayed.

TEMPERATURE DISPLAY
A, B, C, D (E, F) = ZONES
Upper and Lower Heater

UP/DOWN ARROW BUTTONS
Used with other Buttons to scroll through heater and temperature selections.

CROWN BUTTON
Press to enter temperature selections.

CAUTION:

DISPLAYED TEMPERATURES ARE HEATER TEMPERATURES AND DO NOT INDICATE ACTUAL FOOD TEMPERATURES.

NOTE: To reset all calibrations to the factory settings, turn the unit off, then press and hold the UP and DOWN Arrow buttons simultaneously while turning the unit back on. A "P" will appear in the display and all calibrations will be reset to original factory settings.

- The **SET PRODUCT TEMP** menu is used to change the Hold and Cook-More times. Press and hold the **PRINCE CASTLE LOGO** button on the button bar, then immediately press and hold the **MENU/ENTER** button on the button bar until the display shows one of six programming menus.....(hold for about 5 seconds) Use the **UP** or **DOWN** Arrow button to scroll to the **SET TEMP** ↑ ↓ **ENTR** (Set Product Temperature) menu.



- Press and release the **MENU/ENTER** button to enter the programming menu, the display should then read **SEL TEMP XXXX** ↑ ↓ (the **XXXX** is where the product abbreviation is displayed). Use the **UP** and **DOWN** arrows to navigate to the desired product.

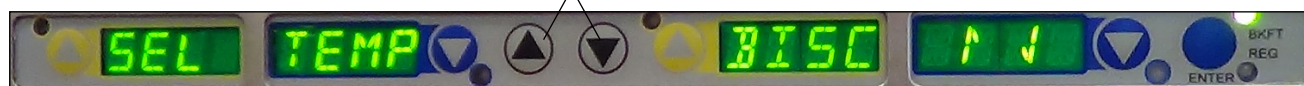

- Press the **MENU/ENTER** button to select that product profile to update, the display will read **SET UPR XXXX ###s** ↑ ↓ the **XXXX** is where the product abbreviation is displayed, and **###** is the temperature. Use the **UP** and **DOWN** arrows to set the temperature of the upper heater of that zone.

Confirm setpoint by pressing **MENU/ENTER**



Setting the Temperature (Continued)

- 4** The display will now show **SET LWR XXXX ###s** ↑ ↓. Use the **UP** and **DOWN** arrows to set the temperature of the Lower heater of that zone. Press **MENU/ENTER** to confirm setpoint temperature.



NOTE: Changing the profile on one bar in a linked system of bin (s) is enough, it does not need to be changed on all bars in the system.

- 5** Press **PRINCE CASTLE LOGO BUTTON** to save the setpoints. Repeat steps 2-5 for all necessary profile upgrades.



NOTE: Setpoints are displayed on the front display board, and should be updated according to the product at this point.

Calibrating Heaters

- 1** Use the following steps to calibrate the individual heaters

Press the **UP** or **DOWN** Arrow button until the desired shelf **LED** and upper or lower heater is selected.

NOTE: Allow sufficient amount of time for temperatures to stabilize before starting calibration. (approx. 30 mins.)



- 2** Take a temperature reading within the shelf near the center of each heater surface.

! WARNING: HOT SURFACES

Use caution when taking temperature readings within the shelf.

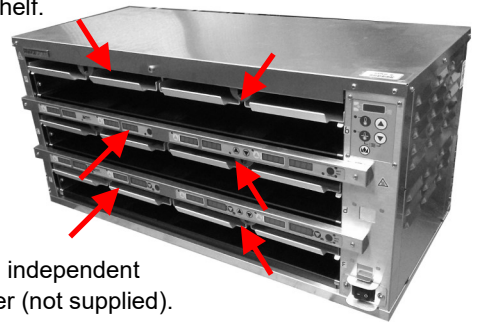

NOTE: Use an independent Temperature meter (not supplied).

- 3** Press and hold the **CROWN BUTTON** and **ACTUAL TEMP** buttons for 5 seconds. The colon (:) LED indicator will light. The temperature displayed is the actual heater temperature sensed by the controller. To clear any offset readings, press the **SETPOINT** button.



- 4** Press the **UP** or **DOWN** Arrow button until the temperature displayed matches the reading obtained in Step 2. Press the **CROWN BUTTON** to save the temperature value and exit the Calibration Mode.

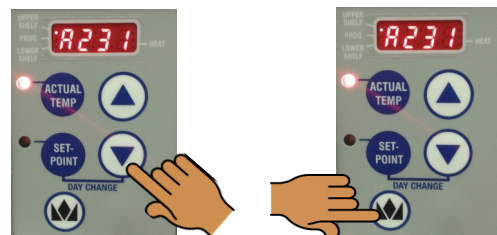

Dedicated Holding Bin

EHB34-CE Series



Changing the Hold and Cook-More Times (Standalone Mode)

- 1** The **SET PRODUCT TIME** menu is used to change the Hold and Cook-More times. Press and hold the **PRINCE CASTLE LOGO** button on the button bar, then immediately press and hold the **ENTER** button until the display shows one of six programming menus. Use the UP or DOWN Arrow button to scroll to the **PROD TIME** ↑ ↓ **ENTR** (Set Product Time) menu.
- Note:** When connected to the Kitchen Minder, this function is disabled.



- 2** Press and release the **ENTER** button to enter the Set Product Time menu. The display will show **BURG TIME** ↑ ↓ **ENTR**. Use the **UP** or **DOWN** Arrow button to scroll through the list of products. When the desired product is displayed, press the **ENTER** button to select it.



NOTE: Holding the **UP** or **DOWN** Arrow button for longer than 2 seconds will cause the product list to automatically scroll up or down.

- 3** The display will show **90** ↑ ↓ **ENTR**.



Use the **UP** or **DOWN** Arrow button to scroll to the desired Hold time. When the desired Hold time is displayed, press the **ENTER** button to save the desired Hold time.



NOTE: Hold time cannot be reduced to less than the Cook-More time plus one minute. **NOTE:** All times are displayed in minutes only. For example, 2 and half hours is displayed as 150

- 4** The display will show **COOK 03** ↑ ↓ **ENTR**.



Use the **UP** or **DOWN** Arrow button to scroll to the desired Cook-More time. When the desired Cook-More time is displayed, press the **ENTER** button to save it.



NOTE: Cook-More time cannot be increased to more than the Hold time, minus one minute.

- 5** The display will show **BURG TIME** ↑ ↓ **ENTR**. Repeat Steps 2 – 4 for any other product. Press and release the **PRINCE CASTLE LOGO** button at any time to exit the Program Mode and return to the Run Mode.

NOTE: If the **ENTER** button has not been pressed to save any changes, the program will revert to the original values.



Changing Product Names (Standalone Mode)

- 1 The **EDIT PRODUCT NAME** menu is used to change a default product name to one of your own choosing. Press and hold the **PRINCE CASTLE LOGO** button on the button bar, then immediately press and hold the **ENTER** button until the display shows one of six programming menus. Use the **UP** or **DOWN** Arrow button to scroll to the **PROD NAME** ↑↓ **ENTR** (Edit Product Name) menu.

Note: When connected to the Kitchen Minder, this function is disabled.



NOTE: Only applicable in stand-alone mode when not connected to Product Management system.

NOTE: The default menu items and names are listed on page 13.

- 2 Press and release the **ENTER** button to enter the Edit Product Name menu. Use the **UP** or **DOWN** Arrow button to scroll through the list of products. When the desired product is displayed, press the **ENTER** button to select it. The first letter (in this case, the **B**) will start blinking.



- 3 To change the blinking **B**, use the **UP** or **DOWN** Arrow button to scroll to the desired letter/number/symbol. When the desired selection is displayed, press the **PAN** Arrow button to move to the next digit. Repeat for all digits.



NOTE: Holding the **UP** or **DOWN** Arrow button for longer than 2 seconds will cause the display to automatically scroll up or down.

- 4 When all four digits have been changed, press the **ENTER** button to select the new name.



- 5 The display will show **PROD NAME** ↑↓ **ENTR**. Repeat Steps 2 – 4 for any other product. Press and release the **PRINCE CASTLE LOGO** button at any time to exit the Program Mode and return to the Run Mode.



NOTE: If the **ENTER** button has not been pressed to save any changes, the program will revert to the original names.

Dedicated Holding Bin

EHB34-CE Series



Changing Temperature Scale (Standalone Mode)

- 1 The **SET F/C** menu is used to change the temperature scale.
Press and hold the **PRINCE CASTLE LOGO** button on the button bar,
then immediately press and hold the **ENTER** button until the display shows one of six programming menus.
Use the **UP** or **DOWN** Arrow button to scroll to the **SET F/C XXXX** $\uparrow \downarrow$ **ENTR** (Edit Product Name) menu.

Note: When connected to the Kitchen Minder, this function is disabled.



- 2 Press the **ENTER** button to enter the menu.
Bar will display **SET DEGR F/C** $\uparrow \downarrow$ **ENTR** and either the **F** or **C** will be blinking.

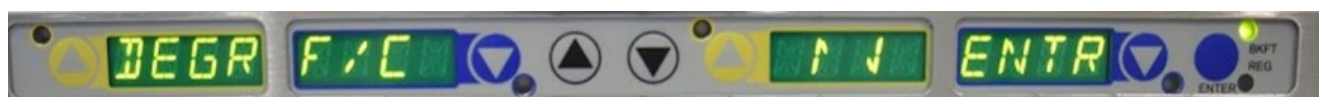

- 3 Use the **UP** and **DOWN** arrows to select the desired temperature mode (the selected mode will blink)
Press the **ENTER** button to confirm the selection. Press the **PRINCE CASTLE LOGO** button to save the setting.



Adjusting Alarm Volume (Standalone Mode)

- 1 The **SET VOLUME** menu is used to change the alarm volume.
Press and hold the **PRINCE CASTLE LOGO** button on the button bar,
then immediately press and hold the **ENTER** button until the display shows one of six programming menus.
Use the **UP** or **DOWN** Arrow button to scroll to the **SET VOL** $\uparrow \downarrow$ **ENTR** (Set Volume) menu.

Note: When connected to the Kitchen Minder, this function is disabled.



NOTE: Only applicable in stand-alone mode when not connected to Product Management system.

- 2 The alarm is included to sound after a hold timer is complete.
The volume is adjustable from level 0-3.
Once the menu is on the bar, press **ENTER** to enter the menu



- 3 Scroll to the desired volume setting and hit **ENTER** to accept.



Selecting the Daypart

- 1 Press and hold the **SETPOINT** button and the **DOWN** Arrow button for 3 seconds, the current day part will begin flashing on the screen.

Use the **up/down** arrows to select day part 1 through 6 and the **Prince Castle Crown** button to confirm your selection.

NOTE: Whenever a bin is powered **ON** it defaults to **DAY PART 1** no matter what time of day it is.

Note: When connected to the Kitchen Minder, this function is disabled.



- 2 To shut down the unit, turn the Power On/Off switch (A) to **OFF** position.



Cleaning



WARNING:

Before performing any maintenance, turn the power switch to the OFF position and unplug the power cord from the electrical receptacle.



CAUTION:

This unit is not watertight. Do not clean with a water jet/jet spray. Do not immerse the unit in water.

1. Turn the unit off and unplug the power cord from electrical receptacle.
 2. Remove the pans and covers. Wipe all parts and unit with a damp cloth.
- DO NOT** use a green Scotch Bright pad cleaner, ice or water.

Dedicated Holding Bin

EHB34-CE Series



Setting Product Location

1 To change a menu selection for a specific pan cavity, use the following steps:

A. Press and hold the **PRINCE CASTLE LOGO** button for 6 seconds. All Pan displays will show **PROG**. All LED Timers will be **RED**.

C. Press the **UP** or **DOWN** Arrow button to scroll to the desired menu item.

D. Press the **ENTER** button to select the menu item.



B. Press a Pan Arrow button to change the menu. The **LED** Timer will change to **YELLOW** and the display will change from **PROG** to the assigned menu item.

E. Repeat steps A – D as required for other Pan displays. Press the **PRINCE CASTLE LOGO** button to exit the Program Mode.

NOTE: A pan may be set as "not used" by assigning " - - - " as its product.

NOTE: Setting a pan to a particular product will automatically change the other pan in that zone to the same product.

2 To shut down the unit, turn the Power On/Off switch (A) to **OFF** position.



(A)

Cleaning



WARNING:

Before performing any maintenance, turn the power switch to the OFF position and unplug the power cord from the electrical receptacle.



CAUTION:

This unit is not watertight. Do not clean with a water jet/jet spray. Do not immerse the unit in water.

1. Turn the unit off and unplug the power cord from electrical receptacle.
 2. Remove the pans and covers. Wipe all parts and unit with a damp cloth.
- DO NOT** use a green Scotch Bright pad cleaner, ice or water.

Default Menu Items

| Burger Products | | | | | |
|------------------|---------------------|-----------|----------------|----------------|----------------|
| Product Name | Kitchen Minder Name | Hold Time | Cook-More Time | Upper Temp (C) | Lower Temp (C) |
| 1.7 Burg | HAMB | 60 | 3 | 102 | 92 |
| Whopper | WHOP | 60 | 3 | 102 | 92 |
| Gourmet | GOUR | 45 | 3 | 102 | 92 |
| Chicken Products | | | | | |
| Product Name | Kitchen Minder Name | Hold Time | Cook-More Time | Upper Temp (C) | Lower Temp (C) |
| Tender Grill | TG | 30 | 3 | 90 | 80 |
| Original Chicken | LONG | 90 | 3 | 125 | 105 |
| Chicken Tenders | TEND | 90 | 6 | 125 | 105 |
| Spicy Chicken | SPCY | 90 | 3 | 125 | 105 |
| Wings | WING | 40 | 3 | 125 | 105 |
| Nuggets | NUGG | 40 | 3 | 125 | 105 |
| Other Products | | | | | |
| Product Name | Kitchen Minder Name | Hold Time | Cook-More Time | Upper Temp (C) | Lower Temp (C) |
| Onion Rings | ONIN | 20 | 3 | 125 | 105 |
| Fish | FISH | 30 | 3 | 125 | 105 |
| | BRL1 | 60 | 3 | 90 | 80 |
| | BRL2 | 60 | 3 | 90 | 80 |
| | BRL3 | 60 | 3 | 90 | 80 |
| | BRL4 | 60 | 3 | 90 | 80 |
| | BRL5 | 60 | 3 | 90 | 80 |
| | BRL6 | 60 | 3 | 90 | 80 |
| | FRD1 | 90 | 3 | 125 | 105 |
| | FRD2 | 90 | 3 | 125 | 105 |
| | FRD3 | 90 | 3 | 125 | 105 |
| | FRD4 | 90 | 3 | 125 | 105 |
| | FRD5 | 90 | 3 | 125 | 105 |
| | FRD6 | 90 | 3 | 125 | 105 |

Zones

All bin configurations are set up with zones, which correspond to a set of heaters that work together to hold the product. A single product can be programmed into each zone.

The timer bars are equipped with this knowledge. If the product in one slot of a zone is changed, the other slot will automatically change to that product as well.

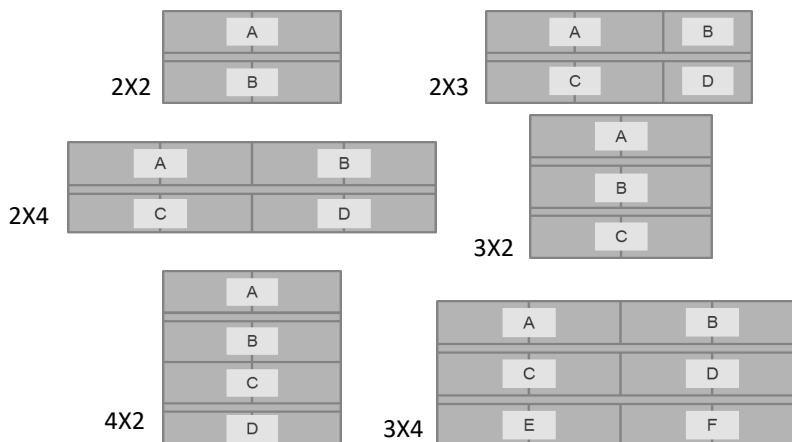

Dedicated Holding Bin

EHB34-CE Series



Troubleshooting

WARNING: To avoid personal injury and possible damage to the unit, troubleshooting and repair of electrical equipment should be performed by qualified service personnel. This unit should be unplugged when servicing. Except when electrical tests are required. Use extreme caution during electrical circuit tests as live circuits may be exposed.

| Problem | Probable Cause | Solution |
|---|--|---|
| No Power | Power switch is turned off, Power cord is not plugged in. | Turn power switch to ON position, Ensure power cord is connected to proper receptacle |
| Unit will not heat up | Wrong power cord, loose connection on power switch and/or heater | CALL TECH SUPPORT 1-800-722-7853 |
| Unit heats up but timer bars do not work | Timer bar wiring disconnected, timer bar is defective | CALL TECH SUPPORT 1-800-722-7853 |
| Unit under/over heats | Check temperature settings | CALL TECH SUPPORT 1-800-722-7853 |
| Display flashes OPN and REL | Open relay, circuit or heater inoperable | CALL TECH SUPPORT 1-800-722-7853 |
| Display flashes SHR and REL | Shorted relay, circuit inoperable, open heater, unplugged ribbon cable | CALL TECH SUPPORT 1-800-722-7853 |
| Display shows HHH for extended period and heat- er surface temperature is hot | Temperature is above 300 F (149 C), Abnormal operation | CALL TECH SUPPORT 1-800-722-7853 |
| Display shows HOLD | Only displayed on a 3X4 Bin display board, when the operator changes the bin address or during calibration | HOLD message means the 2 PC boards in the bin are communicating, wait until the message disappears |
| Display shows WAIT | When in stand alone mode and the oper- ator makes change to the product profile | Wait until the message disappears |
| Display shows INIT | When switching from Kitchen Minder to stand alone mode | Bin is learning Kitchen Minder menus, wait for message to disappear |
| Timer bar displays COMM DOWN | Bin is not communicating with Kitchen Minder | Refer to Kitchen Minder setup manual |

For all technical support in North America, please contact **PRINCE CASTLE LLC 1-800-722-7853**
For technical support worldwide, contact your local service representative / installer.

Diagnostics

DIAGNOSTICS

For all diagnostic messages on the holding bin, the message will appear on the timer bar located at the pan that is triggering the message.

The message is a two-word message that will cycle through on the timer bar in addition to the product name at that pan location.

1. WARM | UP | XXXX – When turning on holding bin the warm up message will appear until heaters reach within 15°F set point.
 - a. Cleared when within 15°F of the set point.
2. HTR | OFF | XXXX – Heater off message appears when both the upper and lower heaters are off.
 - a. Cleared when heater is turned on.
3. HTR | LOW | XXXX – Heater low appears if the temperature falls 15°F below the set point.
 - a. Cleared when temperature is back in range. If not cleared, would require a service technician to repair.
4. HTR | HIGH | XXXX – Heater high appears if the heater is above 285°F for 20 minutes.
 - a. Cleared when temperature is back in range. If not cleared, would require a service technician to repair.
5. RLY | SHRT | XXXX – Relay short error occurs when there is a thermocouple or heater problem.
 - a. Bin requires service to further troubleshoot and repair.
6. RLY | OPEN | XXXX – Relay open error occurs when there is a thermocouple or heater problem.
 - a. Bin requires service to further troubleshoot and repair.
7. COMM | DOWN | XXXX – Communication down error occurs when the temperature data is not being properly communicated.
 - a. Check that unit is in bin1/BAR2/BAR3. Otherwise, requires service technician to troubleshoot.

USB Update Procedure

1. First, un-plug any communication cables from the holding bin. These devices will interfere with the timer bar boot loading process.
2. Place the update files on the USB flash drive in the main directory (Do not put them in a folder on the flash drive). There are five* files that you will need to put on the drive. Two for the controller board, **mainbin.hex** and **DHBFWBIN.TXT**. Three for the timer bars, **mainbar.hex**, **auxbar.hex** and **DHBFWBAR.TXT**.
3. Once all files are on USB drive, turn power off to bin and place the USB drive with the files into USB port on the front of the bin.
4. While holding down crown button on front right side of the bin, above the power switch, turn the power to the bin on.
5. Keeping the crown button pressed, wait for the “BL” (boot load) message to appear on the screen. Release the button approx. 5 seconds after the “BL” message appears or once the USB stick light begins to flash.
6. Wait for the display to show:

| | |
|---|---|
| a. (blank while upgrading main bin firmware) | e. BL02 (2 timer bars left to upgrade) |
| b. BL00 (searching for timer bars to upgrade) | f. BL01 (1 timer bar left to upgrade) |
| c. BL04 (4 timer bars left to upgrade) | g. BL00 (0 timer bars left to upgrade) |
| d. BL03 (3 timer bar left to upgrade) | h. BN04 (4 timer bars detected and done with programming) |
7. You can check the version number on the timer bars by pressing the Prince Castle logo button and the down button on timer bar.

*EHB34XX requires **seven** files. The two additional to those listed are **mainbar2.hex** and **auxbar2.hex**.

Dedicated Holding Bin

EHB34-CE Series



Wiring Diagram

NON-U.S., NON-CANADA, AND NON- BRAZIL ONLY

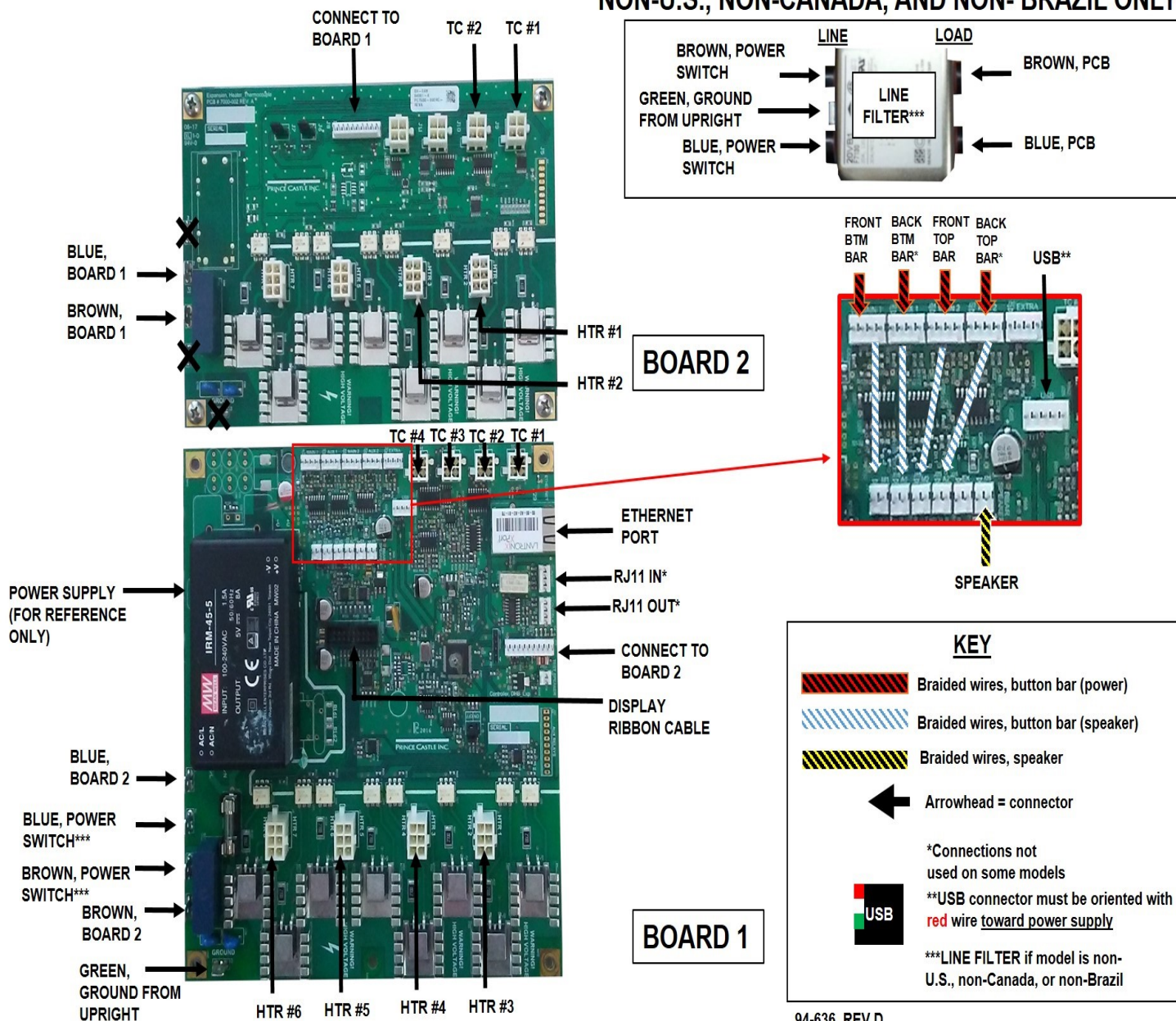

94-636_REV.D

Exploded View

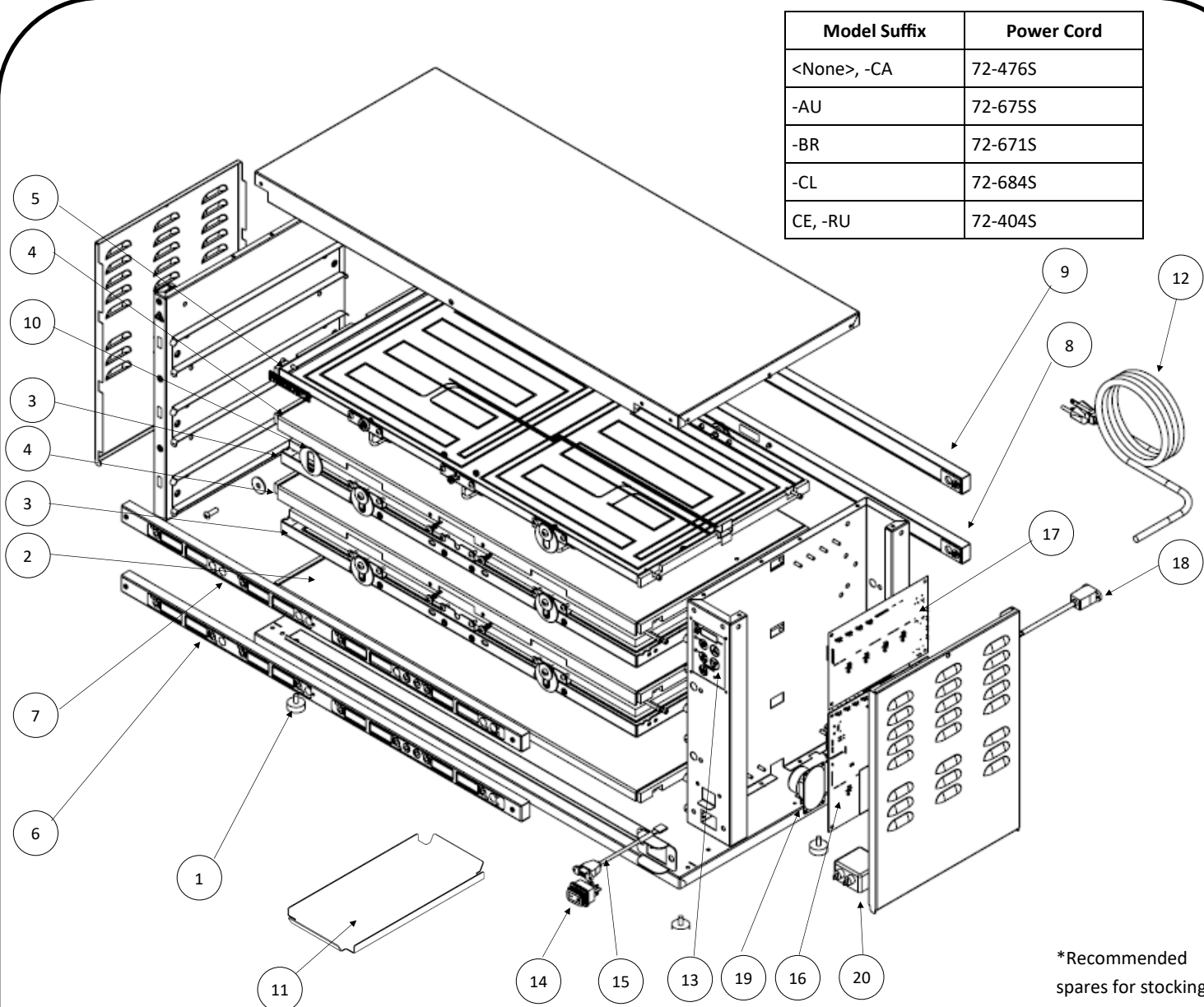

| ITEM NO. | PART NUMBER | DESCRIPTION | ITEM NO. | PART NUMBER | DESCRIPTION | ITEM NO. | PART NUMBER | DESCRIPTION |
|----------|-------------|--------------------------|----------|-------------|----------------------|----------|--------------|-----------------------------|
| 1 | 197-232S | FOOT (4 PACK) | 8 | 510-379S* | TIMER BAR, BACK BASE | 14 | 78-184S | POWER SWITCH |
| 2 | 540-1072S | HTR, BOTTOM SHELF, LOWER | 9 | 510-381S* | TIMER BAR, BACK TOP | 15 | 95-1819S | USB CORD |
| 3 | 540-1226S | HTR, CENTER SHELF, LOWER | 10 | 540-1158S | LATCH, CATCH | 16 | 540-1473S* | BOARD 1 |
| 4 | 540-1224S | HTR, CENTER SHELF, UPPER | 11 | 540-1251S | LID (4 PACK) | 17 | 540-1426S* | BOARD 2 |
| 5 | 540-1222S | HTR, TOP SHELF, UPPER | 12 | USE TABLE | POWERCORD | 18 | 95-2011S* | ETHERNET CONNECTOR |
| 6 | 510-378S* | TIMER BAR, FRONT BASE | 13 | 541-1215S* | OVERLAY, DISPLAY | 19 | 88-709-2-11S | SPEAKER |
| 7 | 510-380S* | TIMER BAR, FRONT TOP | | | | 20 | 88-824S | FILTER (SEE WIRING DIAGRAM) |

Dedicated Holding Bin

EHB34-CE Series



| REV | DATE | DESC. |
|-----|---------|---|
| A | 4/15/19 | RELEASE |
| B | 9/11/19 | UPDATE MODEL TITLE |
| C | 4/29/20 | UPDATED WIRING DIAGRAM REGARDING LINE FILTER |
| D | 7/1/20 | ADDED NOTE TO IN- STALLATION SECTION: "NOTICE – This prod- uct is not intended for connection to the resi- dential public low- voltage supply system" |