

# Operation Manual

## Modular Holding Bin MHB100 Series



**ATTENTION:** Read the instructions before using the machine.

### LIMITED WARRANTY

This product is warranted to be free from defects in material and/or workmanship for a period of One (1) year from date of original installation (with the exception of pans, lids, and covers). Any component which proves to be faulty in material and/or workmanship will be replaced or repaired (at the option of Prince Castle, Inc.) without cost to the customer for parts or labor.

This warranty is subject to the following exceptions/conditions:

- Use of any non-genuine Prince Castle parts voids this warranty.
- All labor shall be performed during regular work hours. Overtime premium will be charged to the buyer.
- Damage caused by carelessness, neglect, and/or abuse (e.g., dropping, tampering or altering parts, equipment damaged in shipment, by fire, flood or an act of God) is not covered under this warranty.

### TABLE OF CONTENTS

MODEL IDENTIFICATION .....	2
SPECIFICATION .....	2
SAFETY INFORMATION .....	2
IMPORTANT .....	2
CONFIGURATION .....	3
PARTS ORDERING .....	4
PRODUCT IDENTIFICATION .....	5
INSTALLATION : BEFORE ASSEMBLY .....	6
INSTALLATION : ADDING MODULES VERTICALLY .....	7
INSTALLATION : ADDING MODULES HORIZONTALLY .....	8
OPERATION : POWER UP .....	9
OPERATION : HOLDING AND CANCELLING ITEMS .....	10
OPERATION : CHANGE DAY PART .....	11
OPERATION : DISPLAY TEMPERATURE .....	12
OPERATION : PREPARING TO CLEAN .....	13
CLEANING .....	14
TROUBLESHOOTING .....	15



355 EAST KEHOE BLVD  
CAROL STREAM, IL 60188  
PHONE: 630-462-8800  
TOLL FREE: 1-800-PCASTLE  
FAX 630-462-1460  
[WWW.PRINCECASTLE.COM](http://WWW.PRINCECASTLE.COM)

### Certifications



Conforms to ANSI/UL 197 CSA 3183199  
Listed CAN/CSA-C22.2 No. 109 Conforms to NSA/ANSI STD

## Model Identification

<b>MHB</b>	<b>100</b>	<b>HM1</b>	<b>—</b>	<b>NA</b>
<b>“Modular Holding Bin”</b>	<b>100 Series</b>	<b>Component Name</b> HM1: Holding Module (100-120 VAC) HM2: Holding Module (208-240 VAC) MB: Main Base EB: Expansion Base		<b>Country Code</b> (North America)

## Specification

Model	Voltage (V)	Watts (W)	Hertz (Hz)
MHB100HM1	100-120 VAC	180 (Each Unit)	50/60
MHB100HM2	208-240 VAC	180 (Each Unit)	50/60
MHB100MB-NA	120 VAC	1440 (MAX)	50/60
MHB100MB-CE	208-240 VAC	1440 (MAX)	50/60
MHB100EB	100-120 VAC	N/A	50/60
MHB100EB-U	208-240 VAC	N/A	50/60

## Safety Information



### WARNING

A Indicates information important to the proper operation of the unit. Failure to observe may result in damage to the equipment and/or severe bodily injury or death.



### CAUTION

Indicates information important to the operation of the unit. Failure to observe may result in damage to the equipment.

## Important

Prince Castle reserves the right to change specifications and product design without notice. Such revisions do not entitle the buyer to corresponding changes, improvements, additions or replacements for previously purchased equipment.

## Configuration

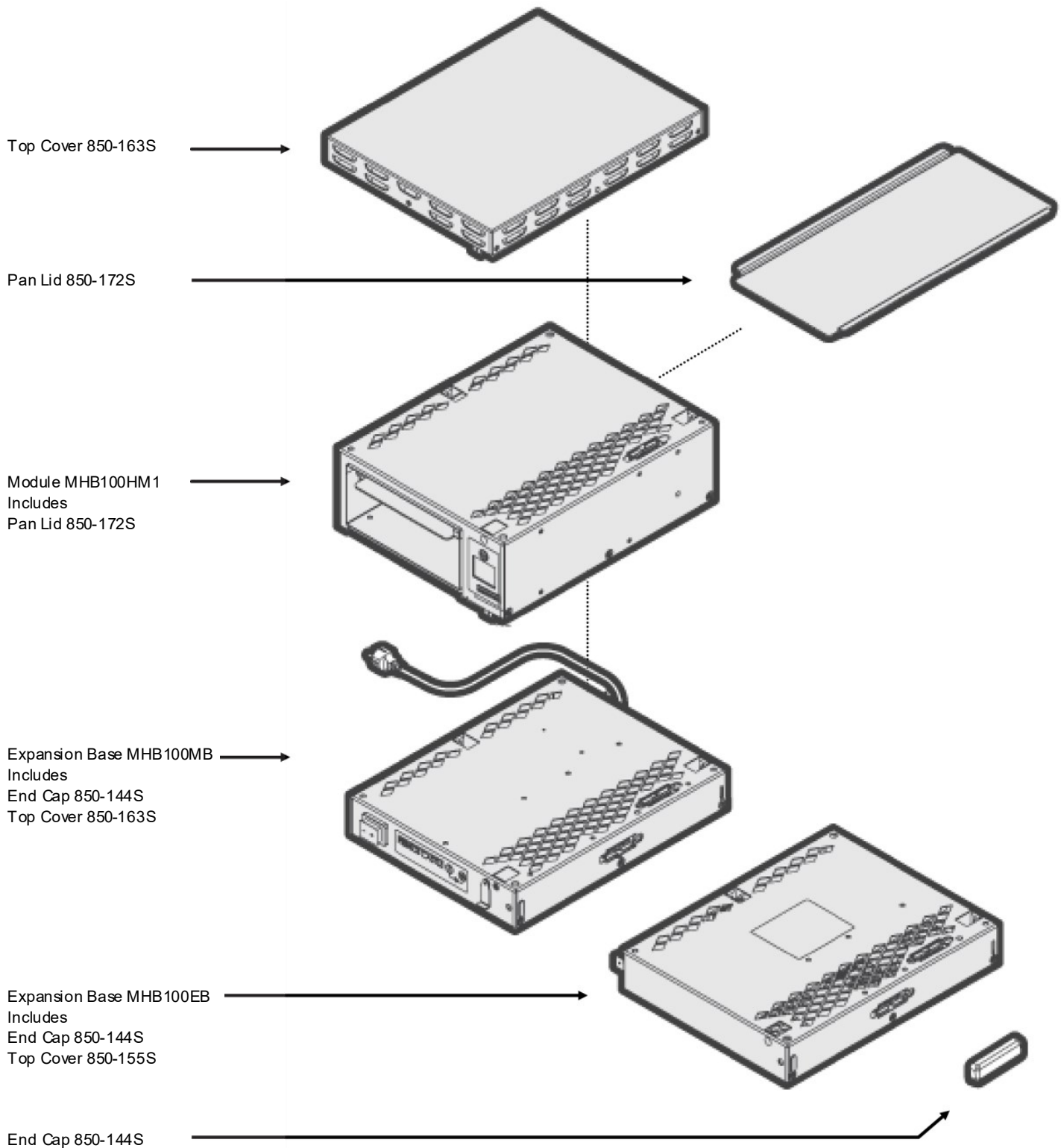

## Parts Ordering

### Top Cover 850-163S

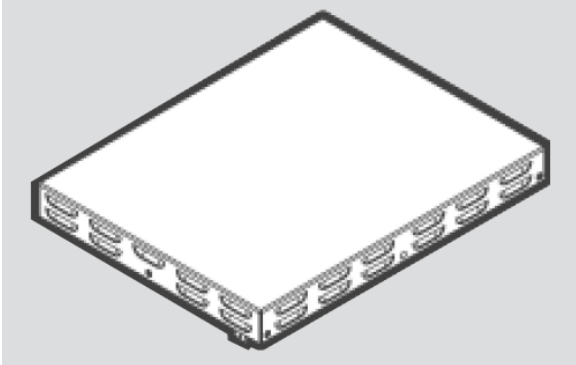

### Module MHB100HM1

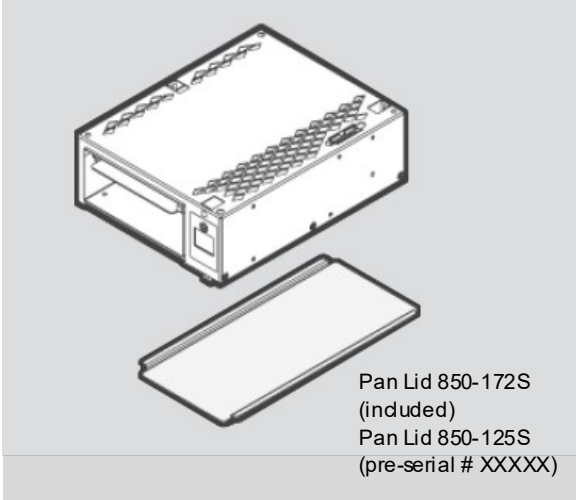

### End Cap 850-144S

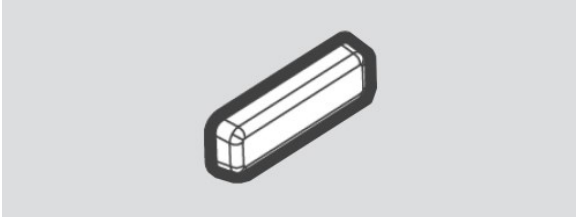

### Main Base MHB100MB

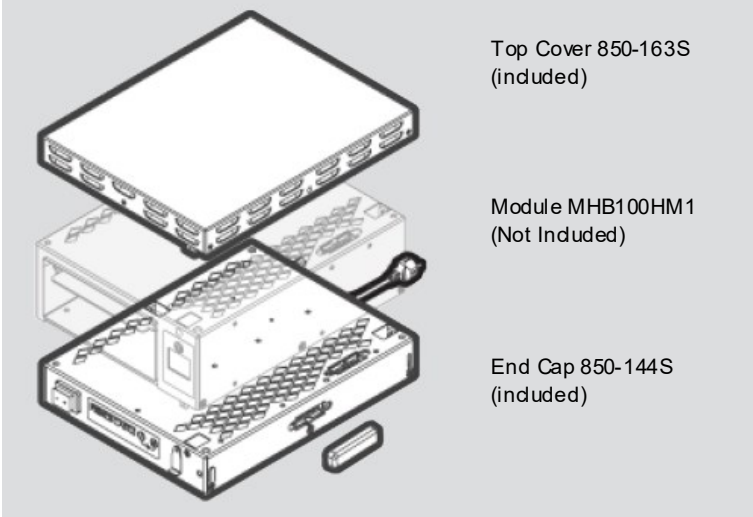

### Main Base MHB100MB

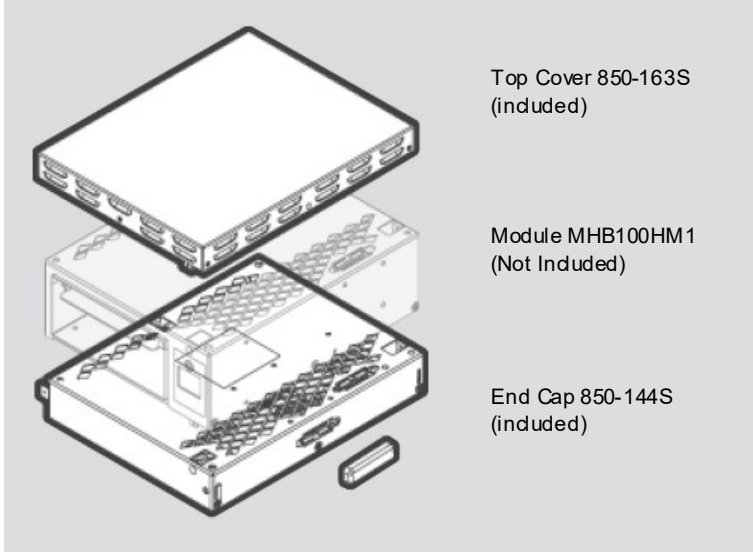

## Product Identification

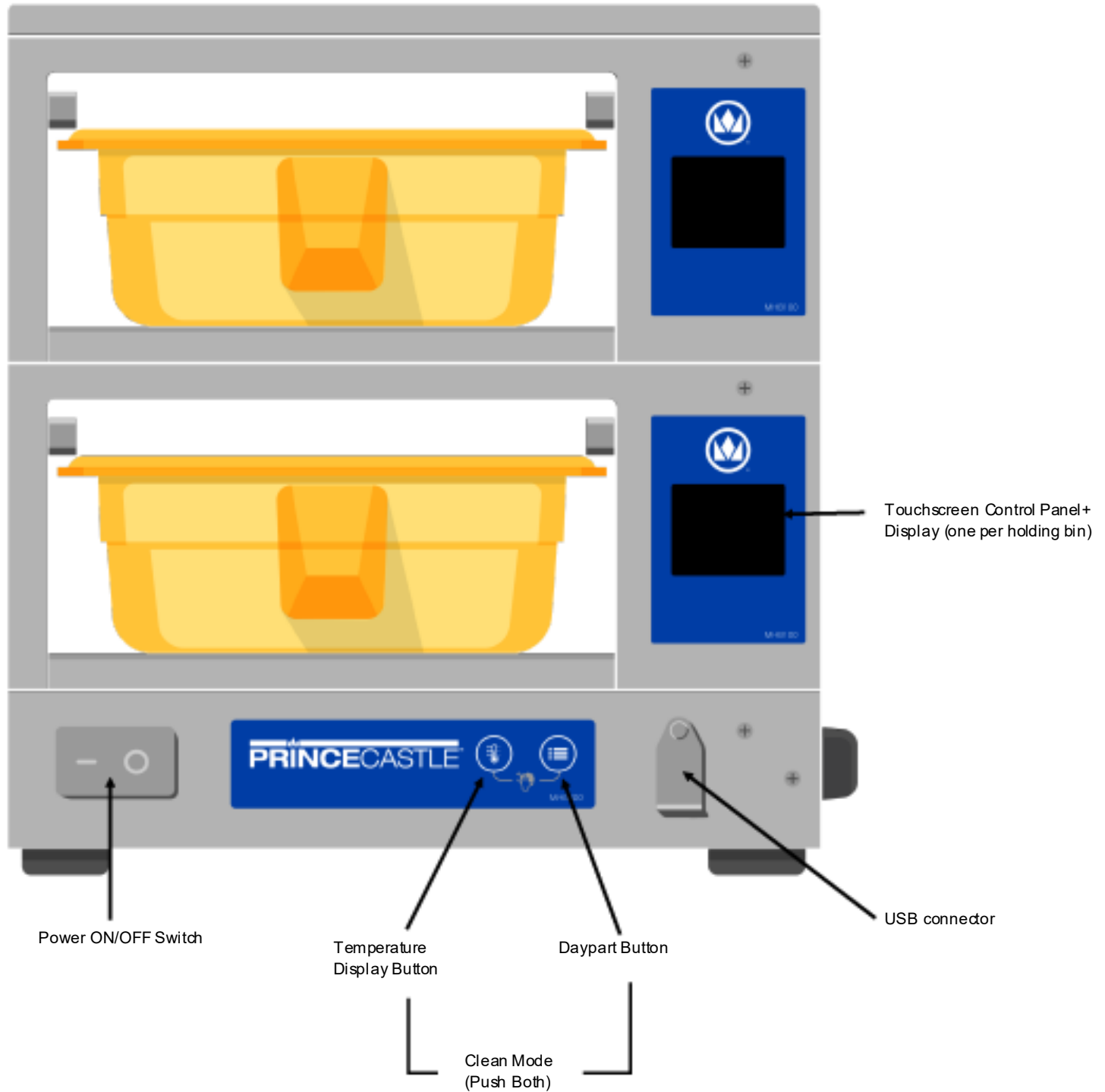

## Installation : Before Assembly

**1**

Remove the unit from the carton and inspect for signs of damage.

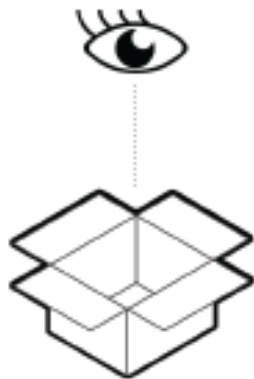

**2**

Always unplug units before assembly or disassembly

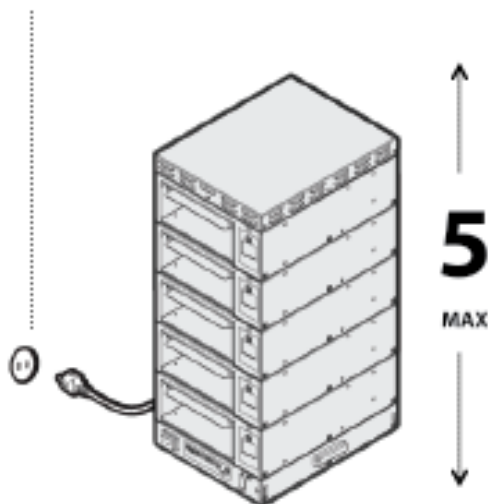

**3**

Always assemble columns first, then assemble rows

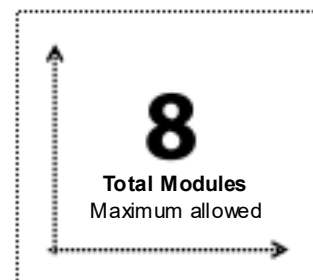

### If unit is damaged:

- Notify the carrier within 24 hours of delivery
- Save carton and packaging materials for inspection purposes
- Contact your local dealer, or if purchased directly, the Prince Castle Sales Department at 800-722-7853 or 1-630-462-8800 to arrange for a replacement unit.

Assemble columns from right to left

Do not assemble more than 5 columns of modules horizontally or vertically

Do not assemble more than 8 total modules in one installation

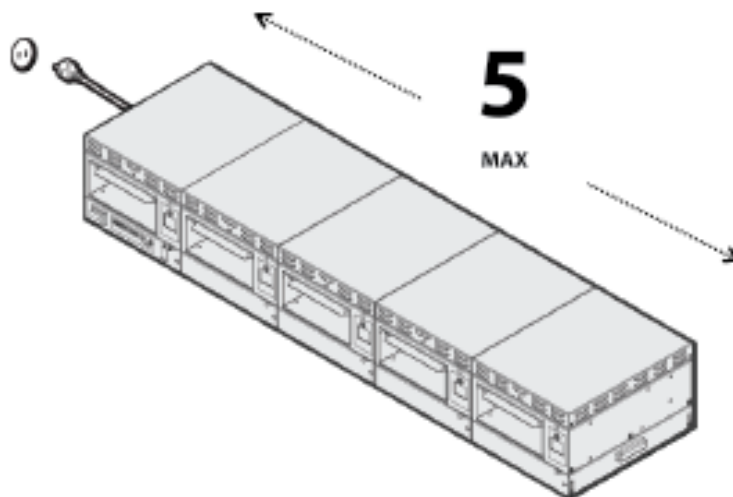



## Installation : Adding Modules Vertically

1

Secure parts using installed screws

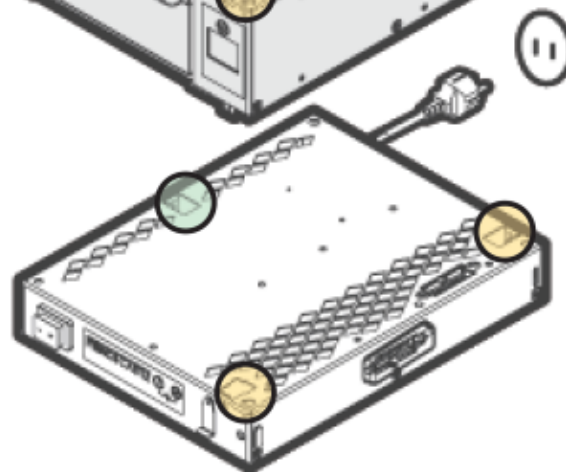
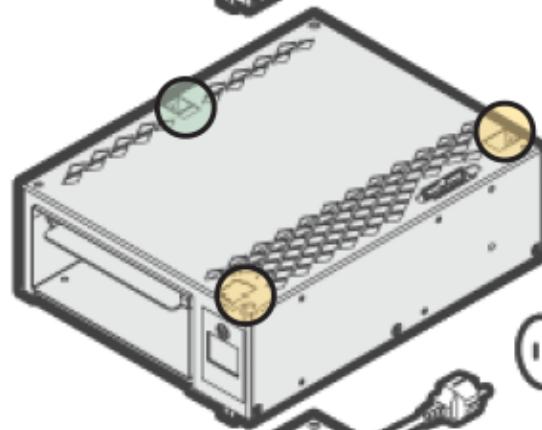
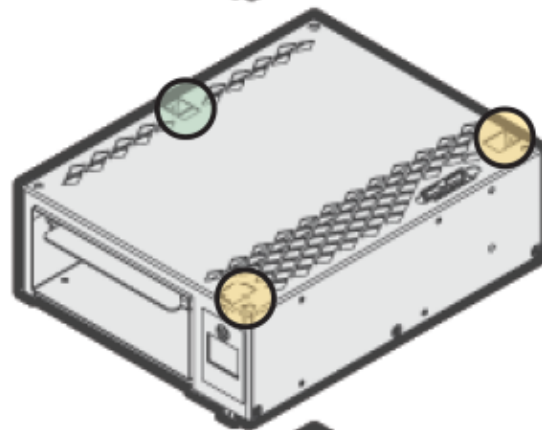
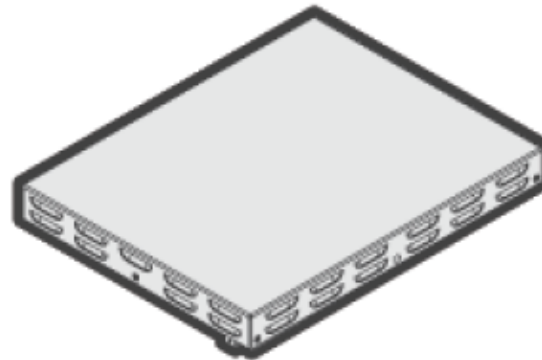
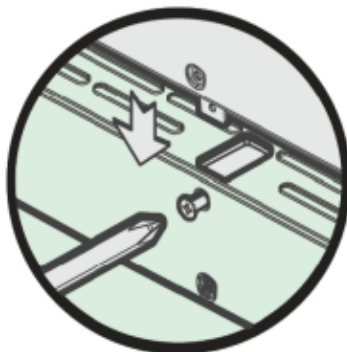
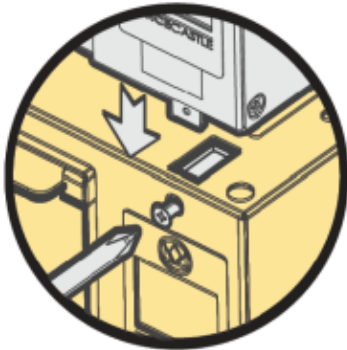

## Installation : Adding Modules Horizontally

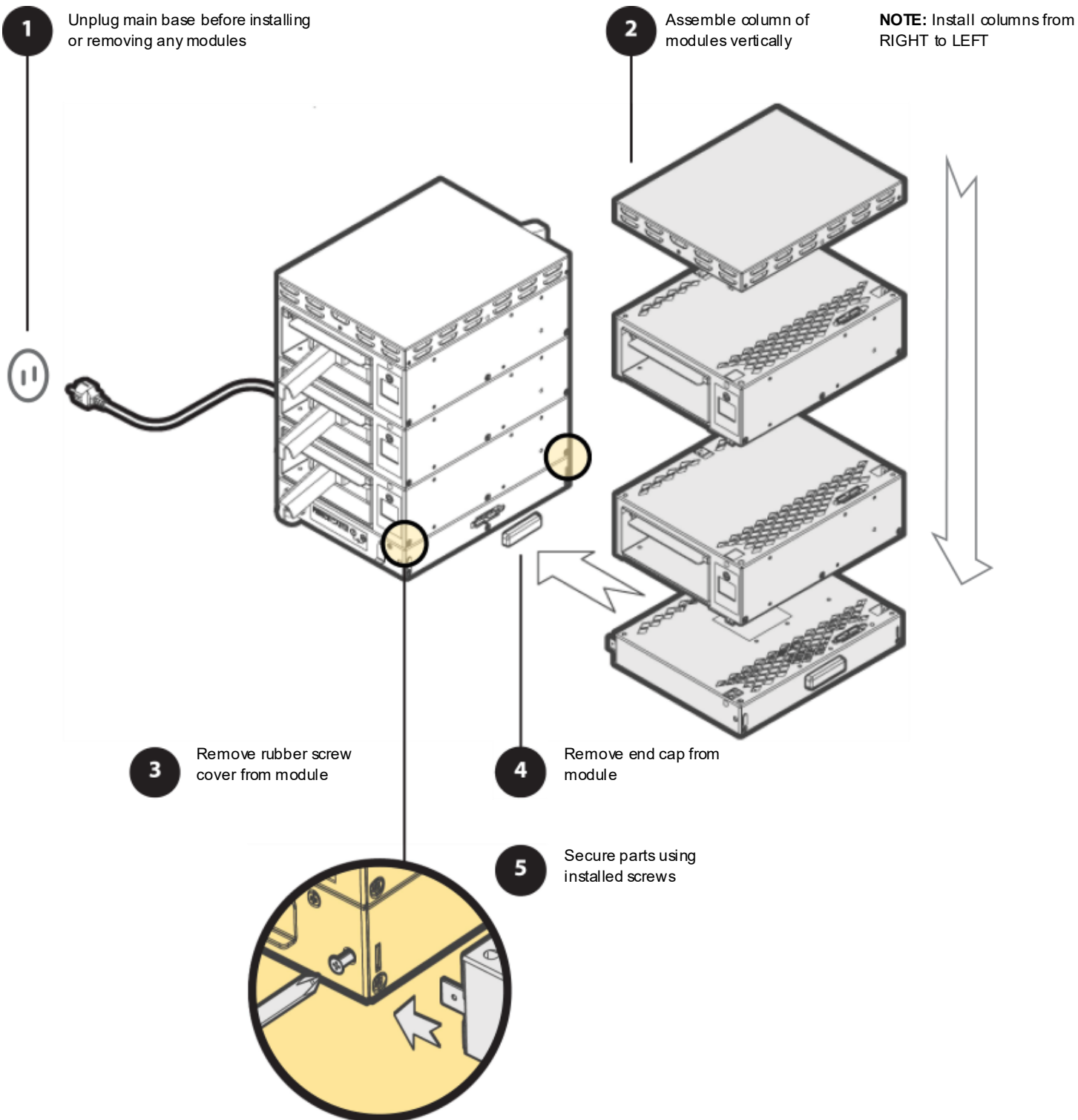



## Operation : Power Up

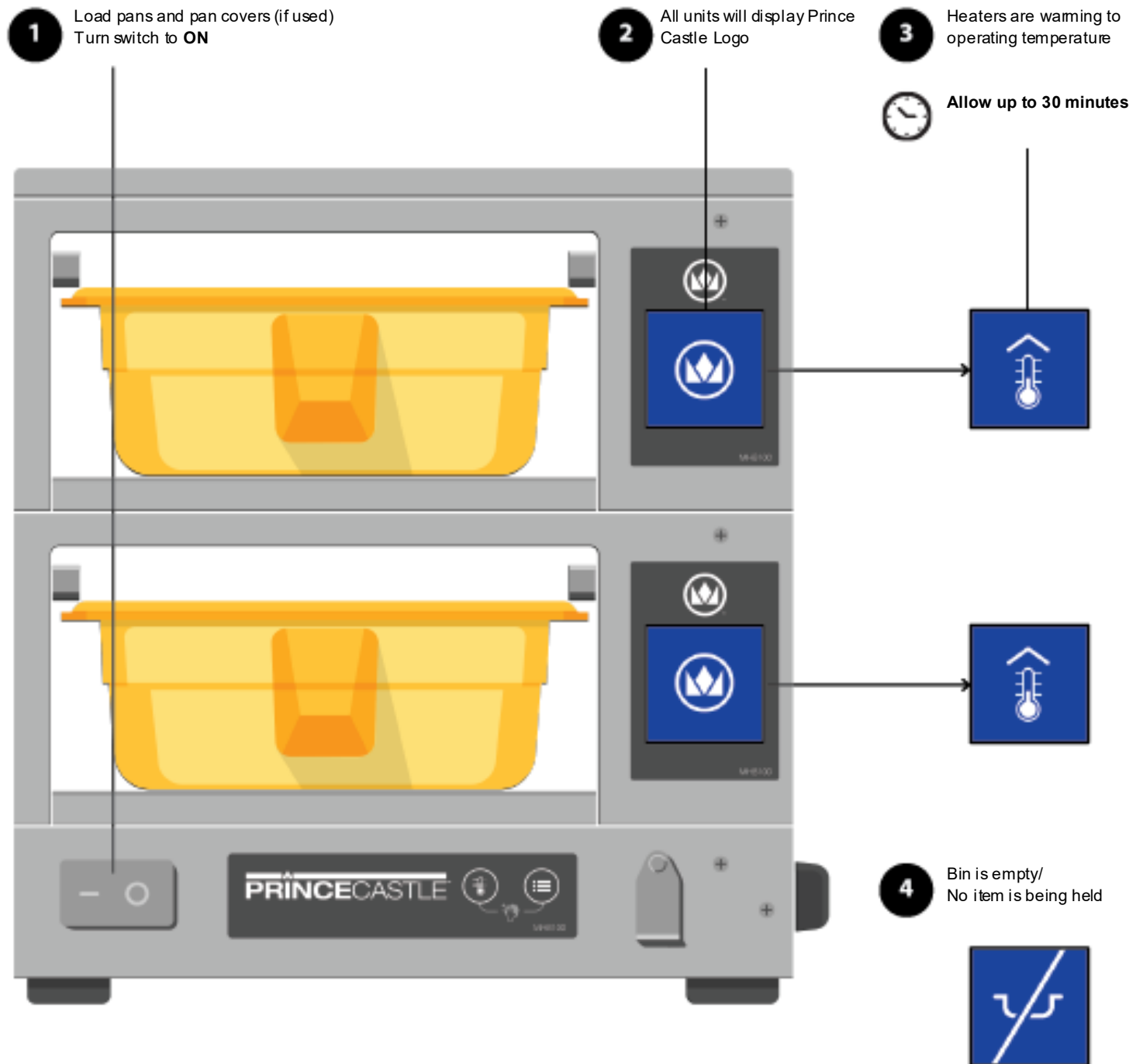

### WARNING

Hot Surfaces

## Operation : Holding and Cancelling Items

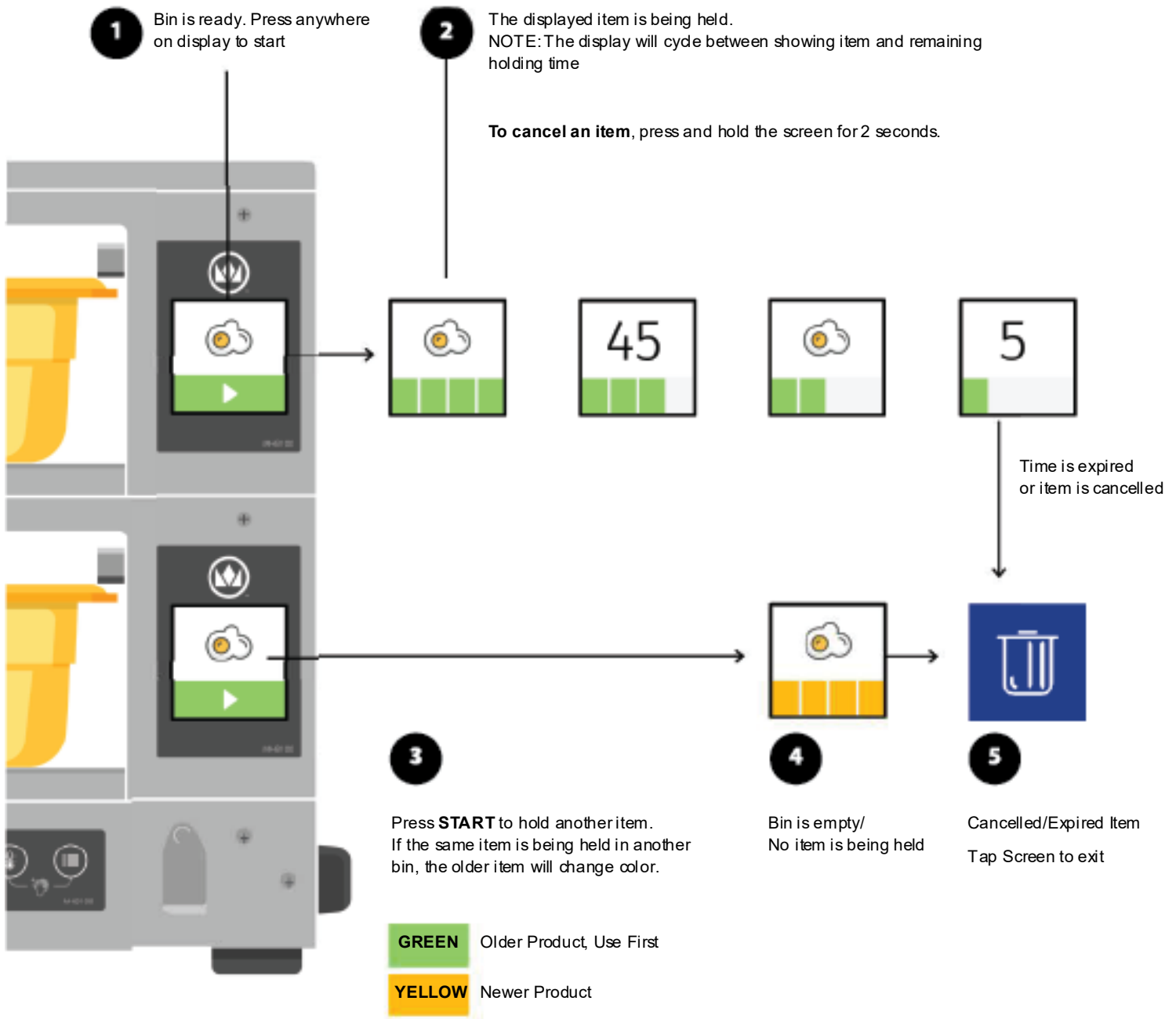

## Operation : Change Day Part

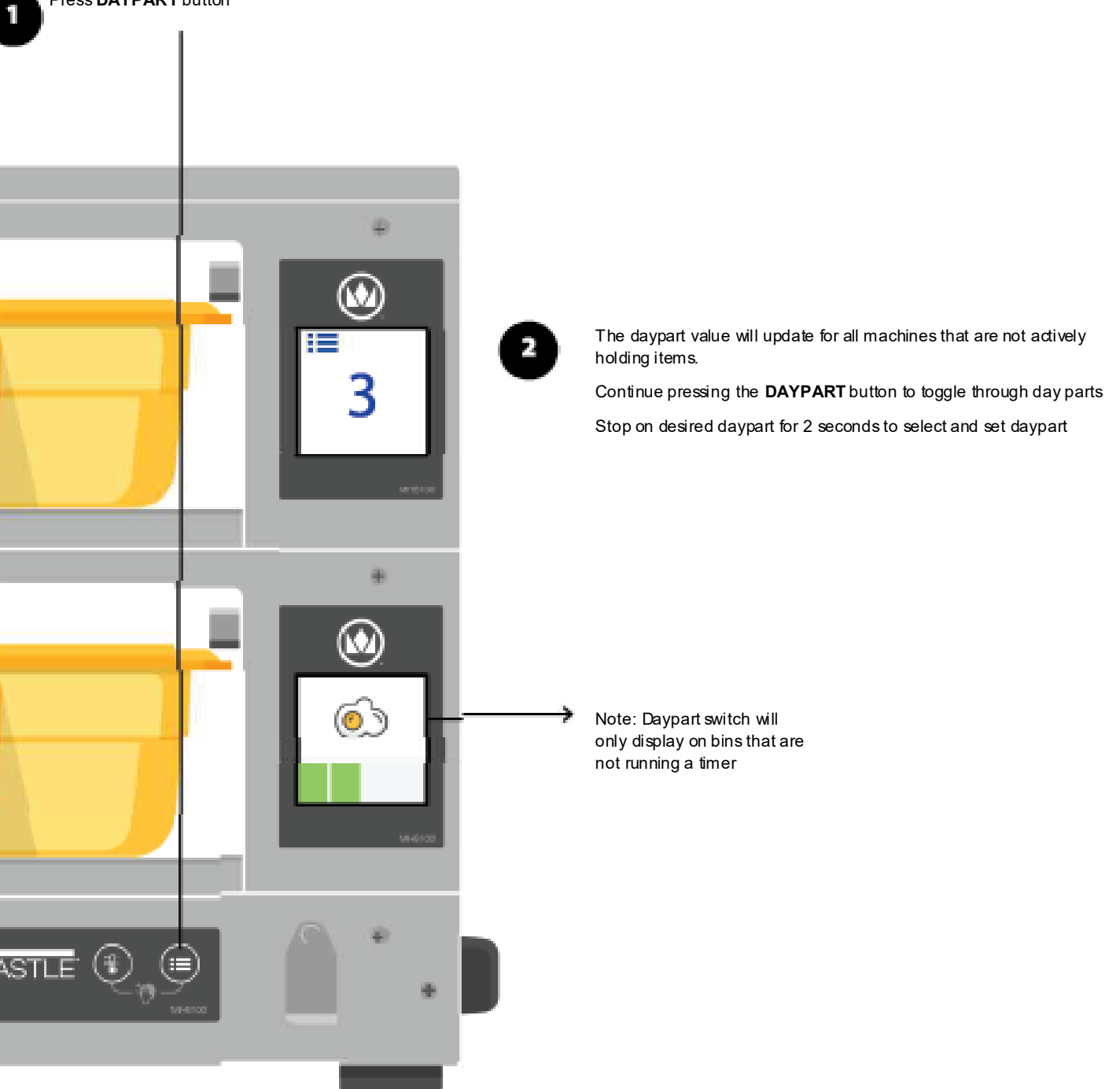

## Operation : Display Temperature

- 1** Press **TEMP** button to display temperature. Press again to exit.

- 2** Temperature will be displayed on all units

 Temperatures are displayed for **30 seconds**, or until TEMP button is pressed again

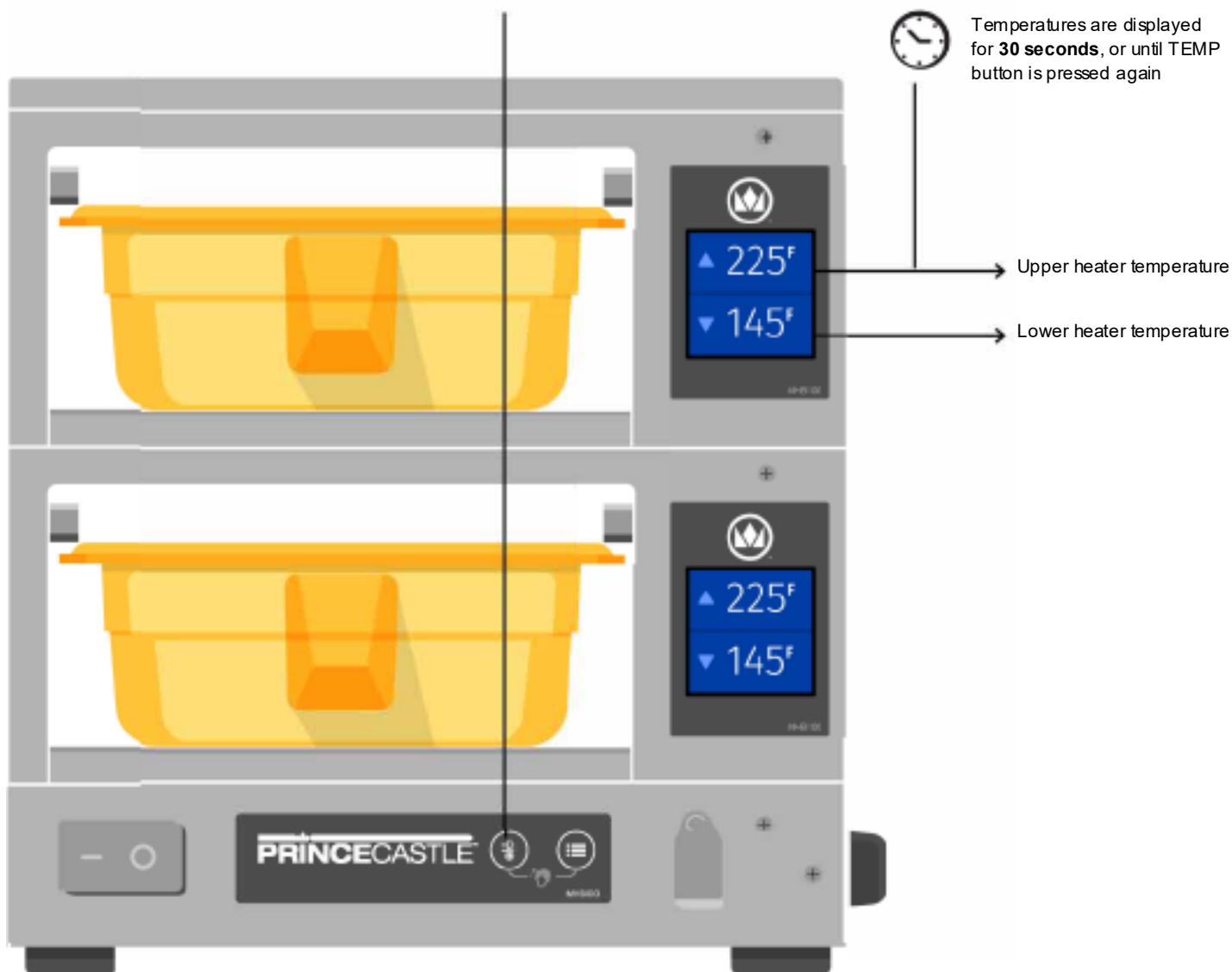

## Operation : Preparing to Clean

- 1** Press both **TEMP** and **DAYPART** buttons to enter cleaning mode
- 2** Units are cooling for cleaning
- 3** Units are ready for cleaning

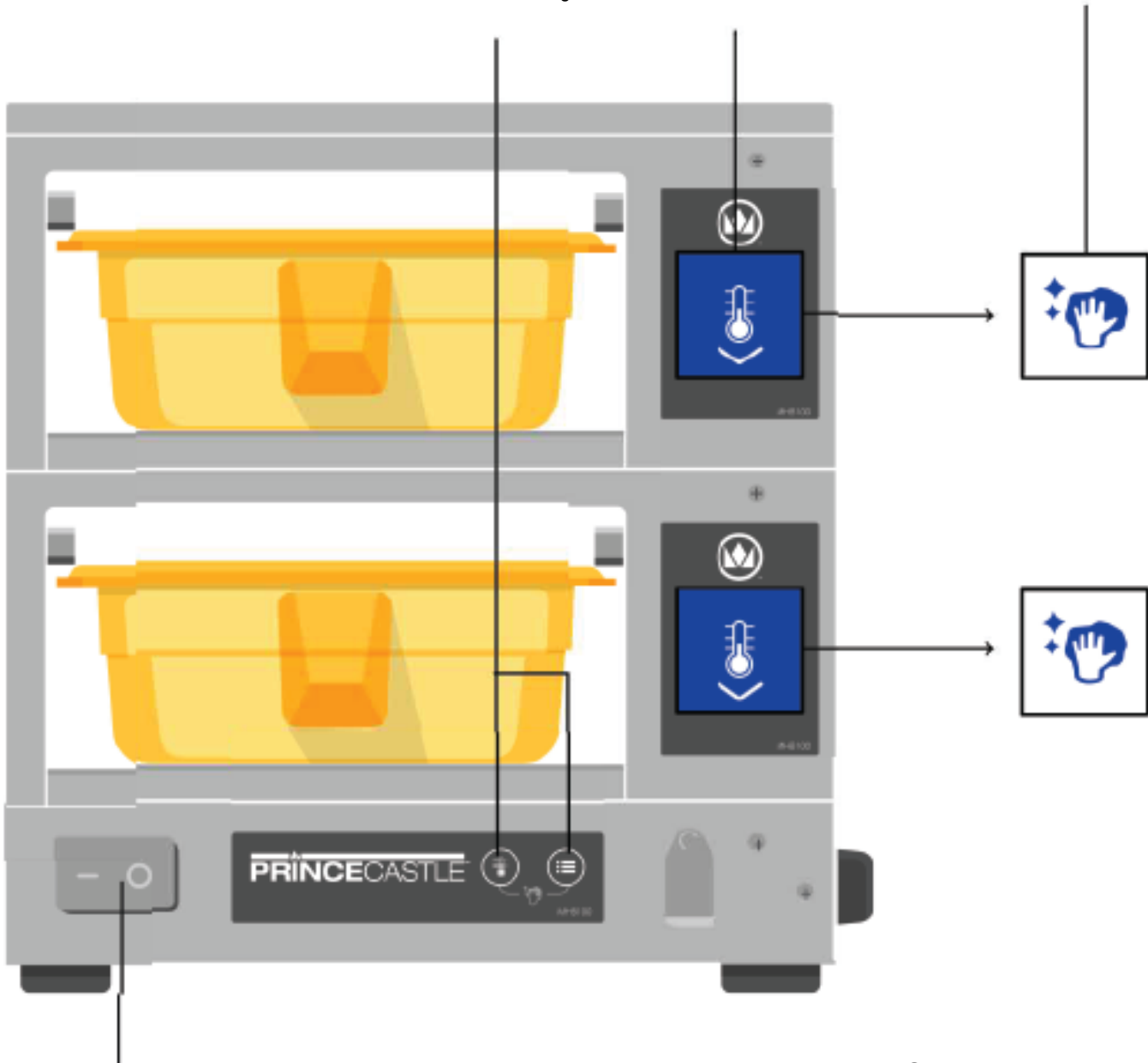

Note: Turn the power switch **OFF**  
then **ON** to exit clean mode



### **WARNING**

Before performing any maintenance, turn the power switch to the OFF position and unplug the power cord from the electrical receptacle

## Cleaning



### WARNING

This unit is not watertight. Do not clean with a water jet/jet spray. Do not immerse the unit in water.



### WARNING

Before performing any maintenance, turn the power switch to the OFF position and unplug the power cord

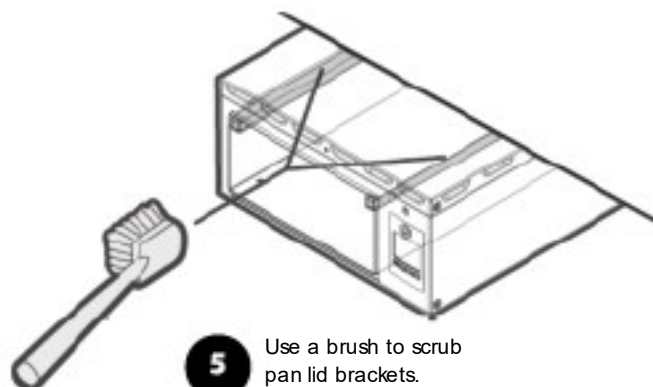
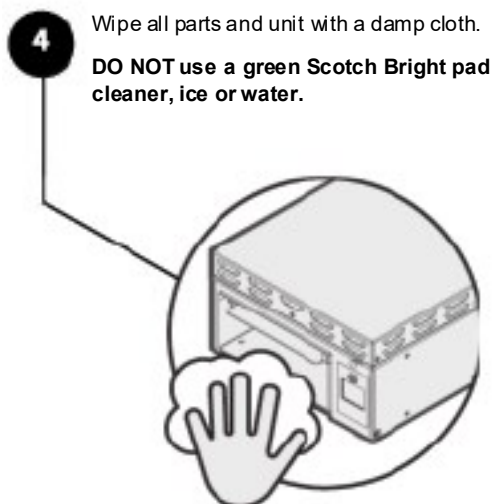
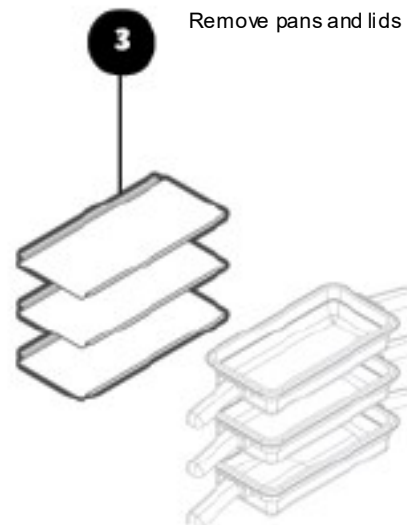
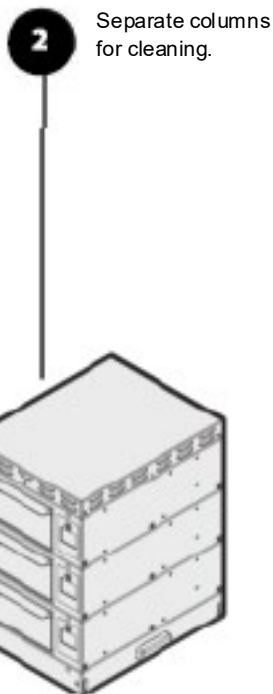
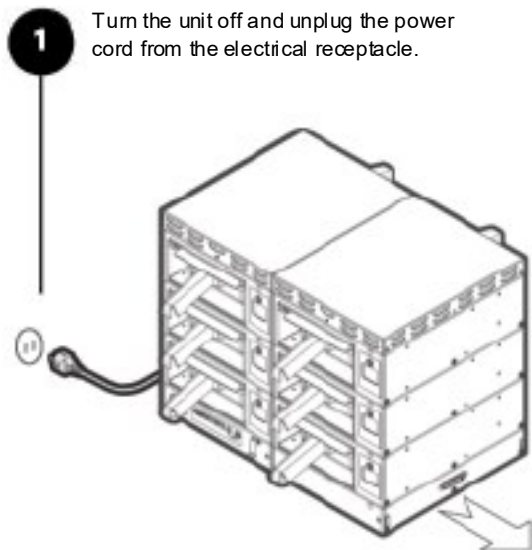



## Troubleshooting



### WARNING

To avoid personal injury and possible damage to the unit, troubleshooting and repair of electrical equipment should be performed by qualified service personnel. Use extreme caution during electrical circuit tests as live circuits may be exposed.

PROBLEM	PROBABLE CAUSE	SOLUTION
<b>No Power</b>	Power switch is turned off. Power cord is not plugged in. Cover or endcap is missing or not connected.	Turn power switch to ON position. Ensure power cord is connected to proper receptacle. Tighten 3 screws on module and cover, ensure endcap is in place at end of last base on the right.
<b>Some units will not heat/power on</b>	Units are not securely connected	Tighten 3 screws on module and cover, ensure endcap is in place at end of last base on the right. Check and tighten screws holding bases together, and ensure expansion bases are powering on properly.
<b>Unit will not heat up</b>	Wrong power cord, loose connection on power switch and/or heater	<b>CALL TECH SUPPORT</b> <b>1-800-722-7853</b>
<b>Unit heats up but display does not work</b>	Timer bar wiring disconnected, module unit is defective	<b>CALL TECH SUPPORT</b> <b>1-800-722-7853</b>
<b>Unit under/over heats</b>	Check temperature settings	<b>CALL TECH SUPPORT</b> <b>1-800-722-7853</b>

CODE	PROBLEM	DESCRIPTION
<b>E01</b>	Upper Sensor Error	<b>Upper Sensor Shorted or Open—Both heaters will shut off</b>
<b>E02</b>	Lower Sensor Error	<b>Lower Sensor Shorted or Open—Both heaters will shut off</b>
<b>E03</b>	Upper Heater Error	<b>Heater open/heating relay shorted closed</b>
<b>E04</b>	Lower Heater Error	<b>Heater open/heating relay shorted closed</b>
<b>E05</b>	Recovery Error	Set point temp not reached in time
<b>E06</b>	Non-volatile Memory Error	Memory corruption in main base
<b>E07</b>	Configuration Error	Unable to set configuration upon power up
<b>E08</b>	USB File Upload Error	Unable to load file from USB due to file corruption
<b>E09</b>	Reserved	
<b>E10</b>	Reserved	
<b>E11</b>	Reserved	
<b>E12</b>	Reserved	
<b>E13</b>	Reserved	
<b>E14</b>	Reserved	
<b>E15</b>	Reserved	

For all technical support in North America, please contact

**PRINCE CASTLE LLC**  
**1-800-722-7853**

For technical support worldwide, contact your local service representative/installer.