



# 248-BC Batch Toaster Bearing Upgrade Kit



Serial # range is from AA 001006 to BD 007304

Installation can be seen live on video at:  
[www.princecastle.com/video/bearingfix.mpg](http://www.princecastle.com/video/bearingfix.mpg)



Make sure unit is unplugged and toaster is cool to the touch before installing the new Lever and Bearing kit.

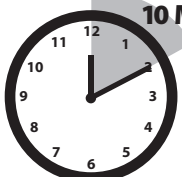

10 Minutes

Install time:  
(approximate)

**10 Minutes**

## NOTE:

### Red Boxes

Indicate disassembly and old part removal

### Green Boxes

Indicate toaster reassembly with new parts

LEFT SIDE

## 1 Disconnect

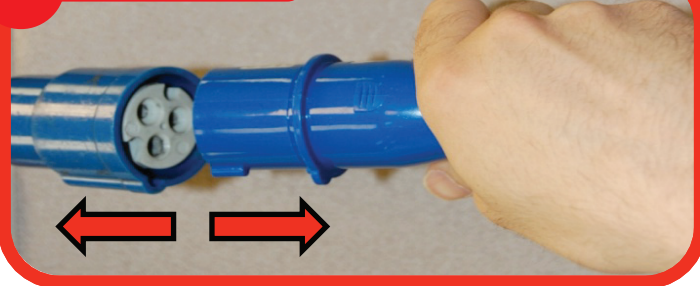

## 3 Loosen



## 5 Loosen



## 7 Remove

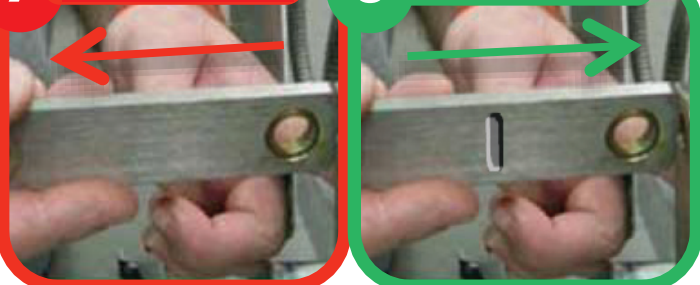

## 8 Position



## 10 Firmly Tighten

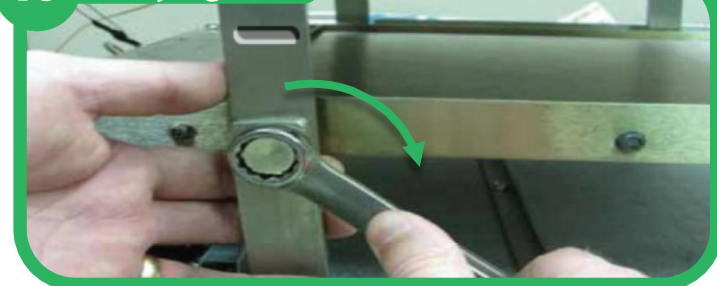

## 12 Position



## 14 Firmly Tighten



## Includes:

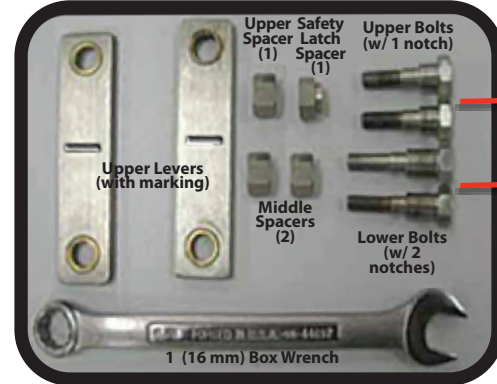

Note: If the current bolts have notches, then the upgrade kit does not need to be performed.

## 2 Lift Up

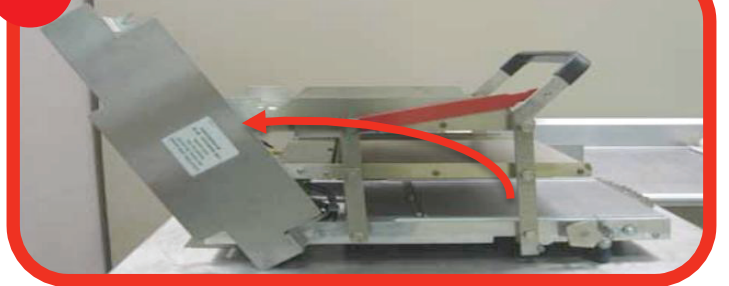

## 4 Remove



## 6 Remove



## 9 Install



## 11 Position



## 13 Position



## 15 Lower Down

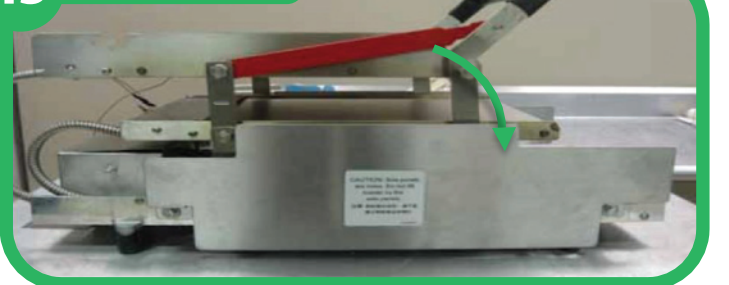





# 248-BC Batch Toaster Bearing Upgrade Kit



Serial # range is from AA 001006 to BD 007304

Installation can be seen live on video at:  
[www.princecastle.com/video/bearingfix.mpg](http://www.princecastle.com/video/bearingfix.mpg)



**NOTE:**  
**Red Boxes**  
Indicate disassembly  
and old part removal  
**Green Boxes**  
Indicate toaster  
reassembly with  
new parts

RIGHT SIDE

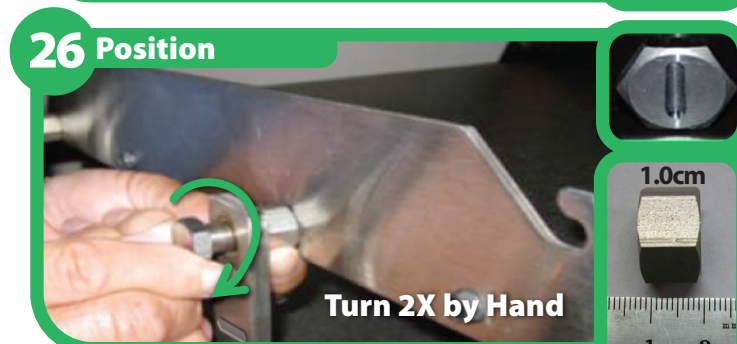
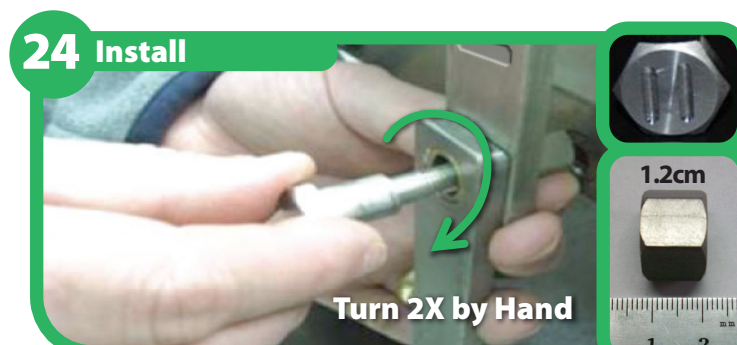
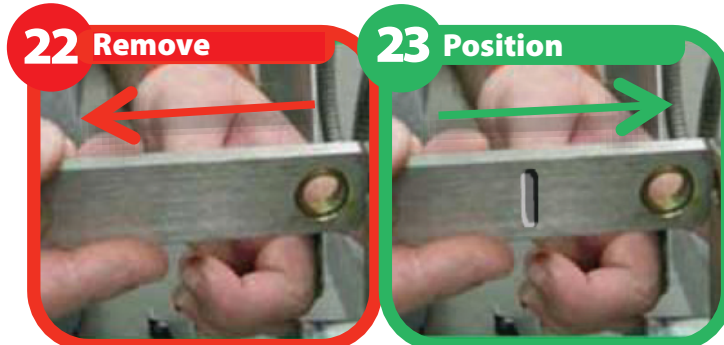
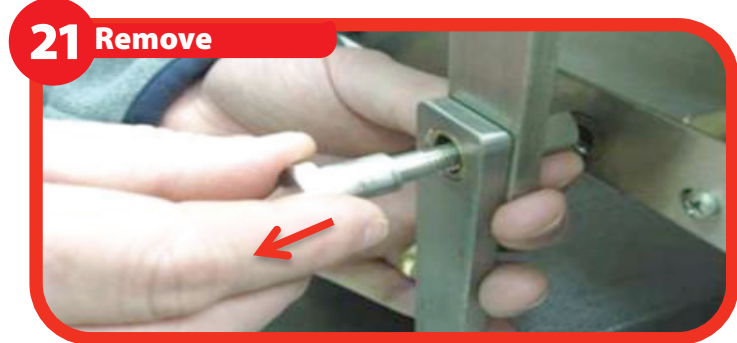
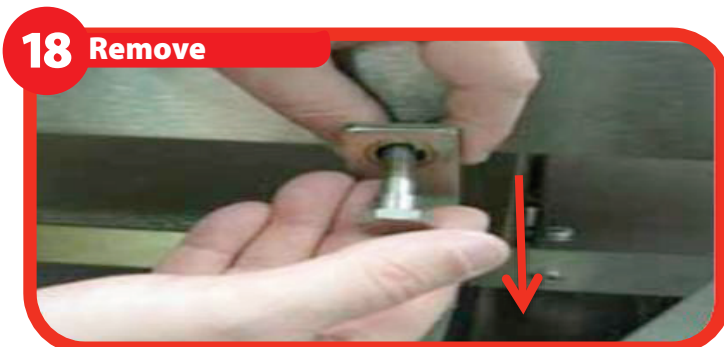
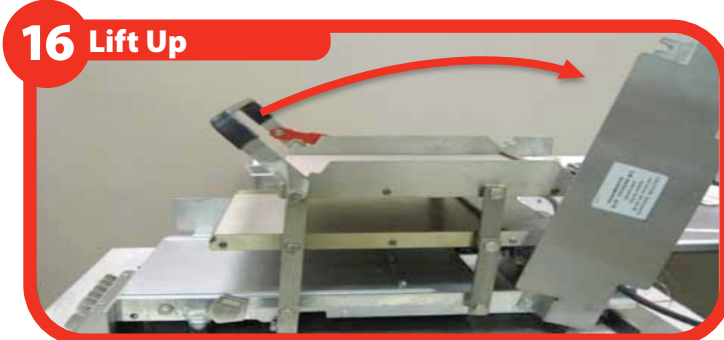

Check accuracy of work by lowering and raising the platens three times.  
Platens should raise and lower without excessive side to side movements and resistance.  
Platen bolts should remain in place.

**Complete**

Note: All bolts and screws should be tightened on a monthly basis